

- Made of high-grade alloy steel. All sliding surfaces are surface-hardened and precision-ground to ensure durability and operational stability.
- Designed for rough and finish machining of aluminum alloy wheels for passenger vehicles.
- Accommodates wheel sizes ranging from 13" to 24" by adjusting the support and sealing surfaces, and replacing the drive arms and jaws.
- Changeable fixtures allow adaptation to various centering methods required in different machining processes, enhancing precision and production flexibility.
- Compatible with CNC lathes, dedicated wheel machining machines, and mill-turn centers.
- Optional matching jaws and drive arms available.

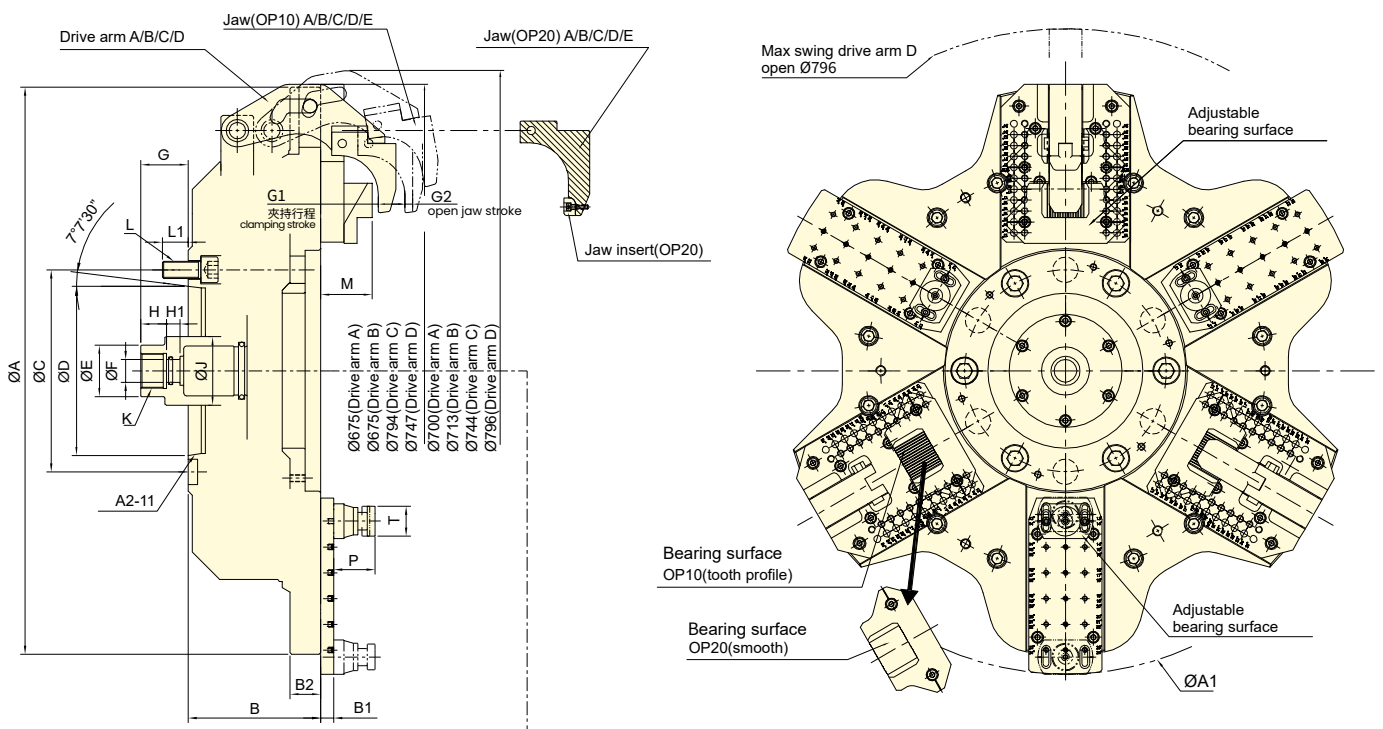

The jig is customized according to the customer's workpiece ID.

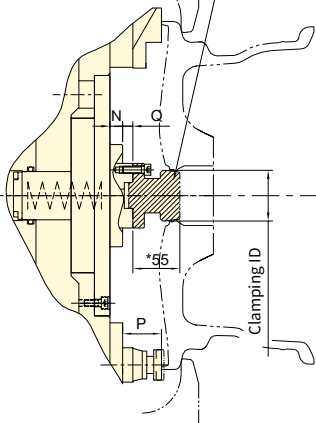

OP10 Centralizing method (spring)

The jig is customized according to the customer's workpiece ID.

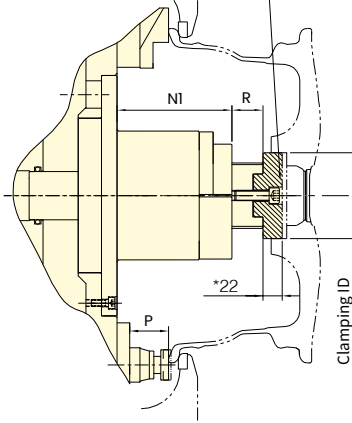

OP20 Centralizing method (thread)

Expanding Collet
The jig is customized according to the customer's workpiece ID.

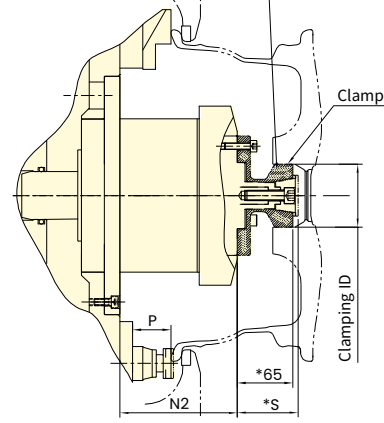

OP20 Centralizing method (Expanding Collet)

* Dimensions may vary depending on the jig size.

SPECIFICATIONS

| Model | | Total axial stroke | Open jaw stroke | Clamping stroke | Max. clamping size of the Wheel | Min. clamping size of the Wheel | Max. D.B. pull | Max. clamping force |
|---------------|------------|--------------------|-----------------|-----------------|---------------------------------|---------------------------------|----------------|---------------------|
| | | mm | mm | mm | inch | inch | kN (kgf) | kN (kgf) |
| 3FW-26 | A11 | 40 | 9 | 31 | 24" | 13" | 34.3(3500) | 30.9(3150) |

| Model | | Max. speed | Moment of inertia | Weight (Jig not included) | Weight (OP10 jig included) | Weight (OP20 jig included) | Matching cyl. | Max. pressure |
|---------------|------------|----------------------------|-------------------|---------------------------|----------------------------|----------------------------|---------------------|-------------------------|
| | | min ⁻¹ (r.p.m.) | kg·m ² | kg | kg | kg | | MPa kgf/cm ² |
| 3FW-26 | A11 | 2200 | 7.3 | 160 | 180 | 190~200 | RE-A1340 RC-1240 | 3.2(33) |

DIMENSIONS

| Model | | A | A1 | B | B1 | B2 | C | D | E | F | G max. | G min. | G1 | G2 | H | H1 | J |
|---------------|------------|-----|-----|-------|----|----|-----|--------|----|------|--------|--------|----|----|----|------|----|
| 3FW-26 | A11 | 660 | 706 | 154.5 | 15 | 36 | 235 | 196.87 | 60 | 26.5 | 55 | 15 | 31 | 9 | 30 | 15.5 | 80 |

| Model | | K | L | L1 | M | N | N1 | N2 max. | N2 min. | P max. | P min. | Q max. | Q min. | R max. | R min. | S max. | S min. | T |
|---------------|------------|---------|-------|----|----|----|-----|---------|---------|--------|--------|--------|--------|--------|--------|--------|--------|----|
| 3FW-26 | A11 | M40x1.5 | 6~M20 | 30 | 60 | 15 | 134 | 220 | 38 | 48 | 42 | 15 | 0 | 106 | 32 | 71.5 | 66.5 | 35 |