

XYSK50GPC20L110

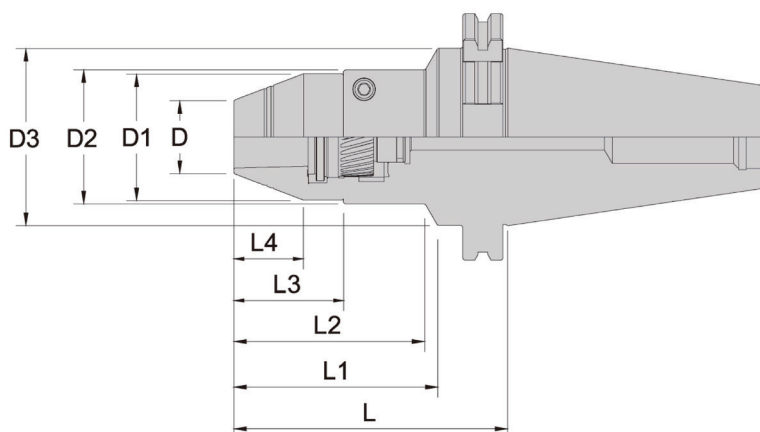

- Provide the center coolant and the side coolant.
- Select the side coolant must to use the collet with coolant slot.
- C type Chuck is used for central outlet.
- Select the PIN Collet.
- Coolant can be sprayed directly into the edge of tool for quick cooling and remove the steel chip.
- At 2.5 magnification, the clamping accuracy is less than or equal to 0.003 mm.



Subject to technical changes

SPECIFICATIONS

MODEL	Range(d)	L	L1	L2	L3	L4	D	D1	D2	D3
XYSK50GPC20L110	4~20	108	81	76	43	28	29	50	53	70

MODEL	min ⁻¹ G2.5	Spanner	Recommend Torsion	Torque Wrench	Center Coolant	Side Coolant	Pin Collet
XYSK50GPC20L110	20000	4MM	10NM		V	V	V