

XYBT-BBT50GPC32L150

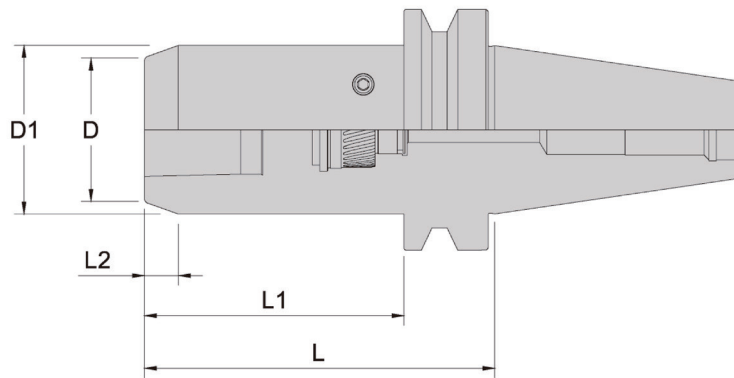

- Provide the center coolant and the side coolant.
- Select the side coolant must to use the collet with coolant slot.
- C type Chuck is used for central outlet.
- Select the PIN Collet.
- Coolant can be sprayed directly into the edge of tool for quick cooling and remove the steel chip.
- At 2.5 magnification, the clamping accuracy is less than or equal to 0.003 mm.

BT BBT 50



Subject to technical changes

SPECIFICATIONS

MODEL	Range(d)	L	L1	L2	L3	L4	D	D1	D2	D3
XYBT50GPC32L150	12~32	145	108	14	-	-	60	70	-	-
XYBBT50GPC32L150	12~32	145	108	14	-	-	60	70	-	-

MODEL	min ⁻¹ G2.5	Spanner	Recommend Torsion	Torque Wrench	Center Coolant	Side Coolant	Pin Collet
XYBT50GPC32L150	20000	4MM	10NM		V	V	V
XYBBT50GPC32L150	20000	4MM	10NM		V	V	V