

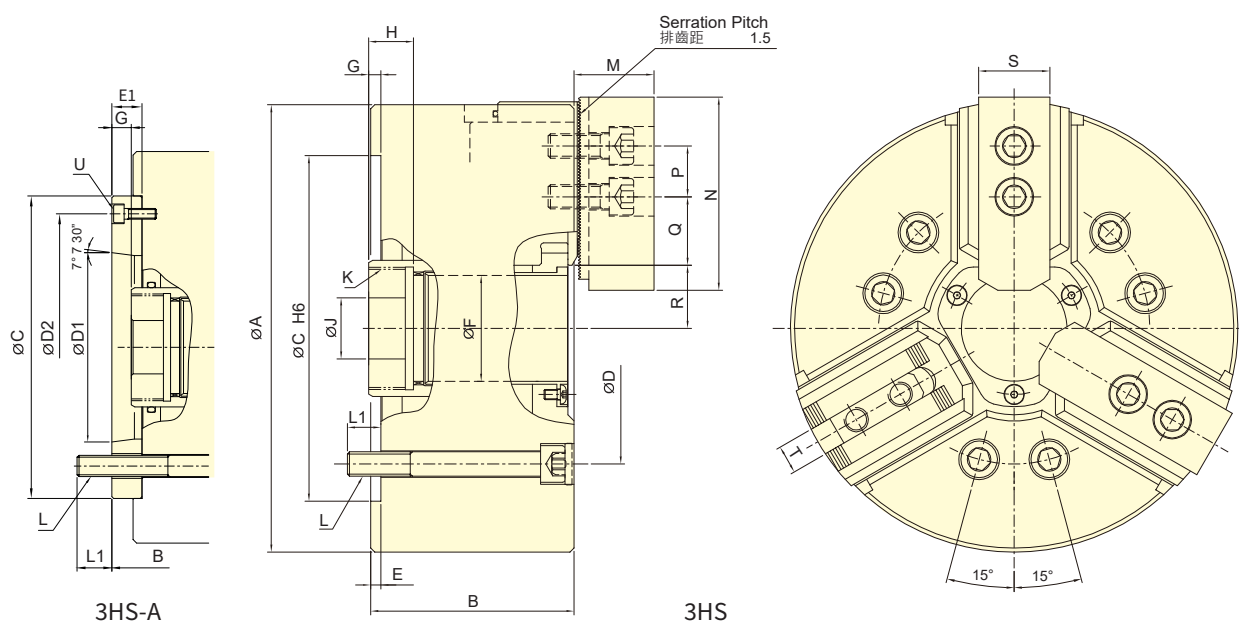

- 全密封式設計，大幅降低保養頻率，提高生產效率。
- 夾頭內部可長時間潤滑，能防止切削水、切屑或異物的滲入，確保夾持精度與耐用度。
- 推薦適合無人化作業場合、鑄件和鍛件的乾式加工、高壓冷卻液下加工使用。特別適合使用於立式車床。
- 可依自動化生產需求訂製中心注水或注氣(選配)。
- Fully sealed design extends maintenance intervals, improving production efficiency.
- Sealed design ensures constant lubrication and protects against the ingress of coolant and chips, which guarantees clamping precision and durability.
- Suitable for lights-out manufacturing; dry machining of castings and forgings; or when high-pressure coolant is utilized. Especially ideal for vertical lathes.
- Media fed through central bore - available for coolant or air. (optional)



保留規格修改的權利 Subject to technical changes

### 技術規格 SPECIFICATIONS

型號	楔心行程	爪行程 (直徑)	夾持直徑 Chucking Dia.		容許最大入力	最大夾持力	最高迴轉數	I	重量		適用迴轉缸	最大使用壓力	
Model	Plunger stroke	Jaw stroke (Dia.)	最大 Max.	最小 Min.	Max. D.B. pull	Max. Clamping force	Max. speed	Moment of inertia	Weight	Matching cyl.	Max. pressure		
	mm	mm	mm	mm	kN (kgf)	kN (kgf)	min <sup>-1</sup> (r.p.m.)	kg · m <sup>2</sup>	kg			MPa (kgf/cm <sup>2</sup> )	
<b>3HS-08</b>	<b>A6</b>	18	7.6	220	22	31.9(3250)	92(9380)	5000	0.18	26.5	<b>28.1</b>	TK-A853	2.6(26)

### 外型尺寸 DIMENSIONS

Model	A	B	C	D	D1	D2	E	E1	F	G max.		G min.		H	J		
<b>3HS-08</b>	<b>A6</b>	220	98	<b>110</b>	170	133.4	<b>106.38</b>	<b>150</b>	5	<b>17</b>	52	20	<b>15</b>	2	<b>-3</b>	20	30
Model	K max.	K Default	L	L1		M	N	P	Q max.	Q min.	R max.	R min.	S	T	U		
<b>3HS-08</b>	<b>A6</b>	M60x2	M55x2	6~M12	19	<b>17</b>	39	95	25	47.75	29.75	29	25.2	35	14	<b>3~M6</b>	

紅色數據為 3HS-A 型之尺寸 (The dimensions and the specifications of 3HS-A type are in red data.)