

- Indexing operates during the spindle rotation, can perform a quick change between multiple working axes.
- All parts of chuck hardened, ground and lubricated directly.
- Sealed against swarf, chips and coolant.
- High rigidity and high repeatability precision.
- Unique indexing system and hydraulic system, with pressure detection device in chuck, high reliability.

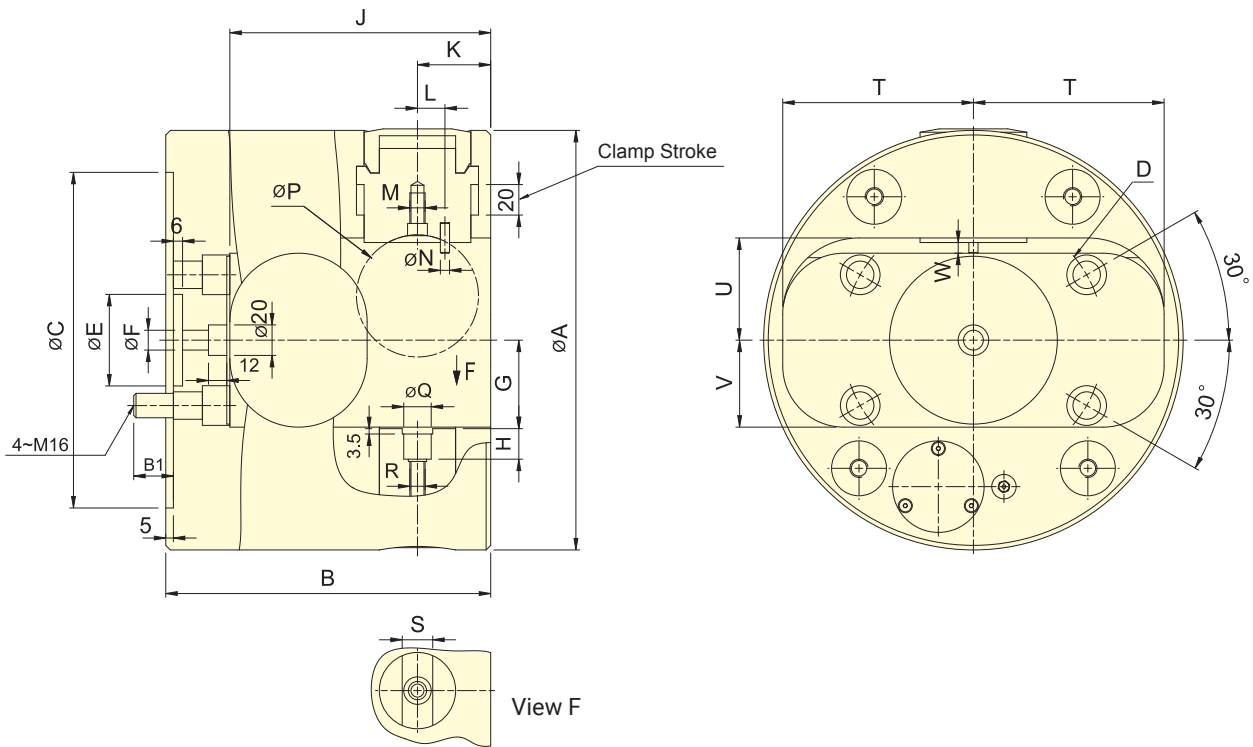

Subject to technical changes

SPECIFICATIONS

Model	Index Angle Deg	Jaw stroke mm	Chucking Area		Max. pressure kgf/cm ²	Max. Clamping force kN (kgf)	Max. speed min ⁻¹ (r.p.m.)	I Moment of inertia kg·m ²	Weight kg	ROTATING JOINT	Main Spindle Bore mm
			Dia Max. mm	Len Max. mm							
IS-254	4x90°	20	65	160	45	19.5(1990)	2400	0.41	41	IS-315	86+0.1
IS-275	4x90°	20	80	220	45	25.4(2590)	2100	0.61	52	IS-315	86+0.1
IS-315	4x90°	20	100	230	45	25.0(2550)	1800	1.13	76	IS-315	86+0.1

DIMENSIONS

Model	A	B	B1	C(H6)	D	E	F	G	H	J	K
IS-254	254	190	23	220	171.4	60	13	47.5	18	155	48
IS-275	275	213	26	220	171.4	60	13	58	20	171	48
IS-315	315	232	22	220	171.4	60	13	71	18.5	187	50

Model	L	M	N	P	Q(H7)	R	S(H7)	T	U	V	W
IS-254	13	M8	5	48	18	M10	20	106	57	46.5	5.5
IS-275	18	M10	6	80	18	M10	20	125	67	57	7
IS-315	18	M10	6	75	24	M12	25	125	85	70	7.5

*Index Angle 8x45° or Specific Angle, Please contact AUTOGRIP for more detailed information.Thanks.