

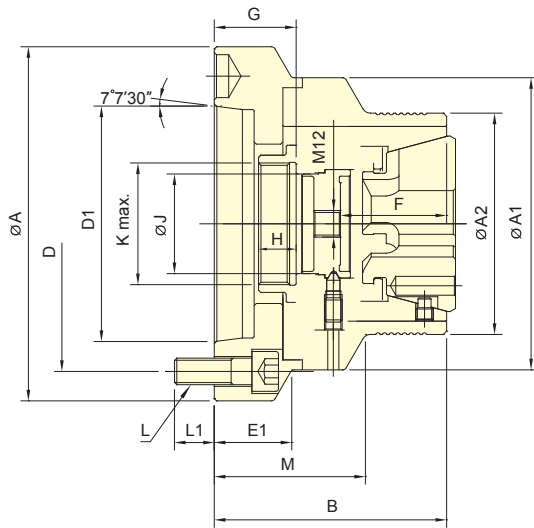

- Clamping push with the backgauge block mechanism, collet will not be pushed, can precise positioning for workpiece length, make the precision of the length control more precise.
- Match Autogrip Rubber collet, clamping direction perpendicular to axis, never occur that situation of collet push workpiece.
- Backgauge block and cover able to interchangeable use, as well as application and chip-proof function.
- J is the hole diameter of blank draw nut.
K is the maximum thread specification and it could be customize.

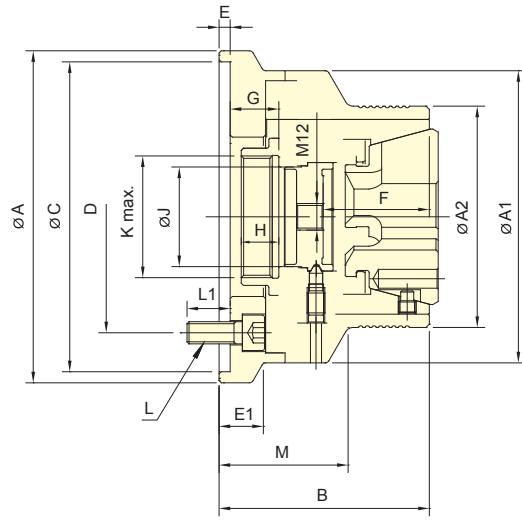

CBD-A



CBD

Subject to technical changes

SPECIFICATIONS

Model	Plunger stroke	Max. Chucking Capacity			Max. D.B. pull	Max. clamping force	Max. speed	Weight	Matching steel collet	Matching Cyl.	Max. pressure	
		Round	Hexagom	Square								
	mm	mm	mm	mm	kN (kgf)	kN (kgf)	min ⁻¹ (r.p.m.)	kg			MPa (kgf/cm ²)	
CBD-52	4.5	4~52	7~36	7~45	39.2(4000)	92.1(9400)	7000	7.3	RG-52	TK-A853	3.2(32)	
CBD-5212	4.5	4~52	7~36	7~45	39.2(4000)	92.1(9400)	7000	7.1	RG-52	TK-A853	3.2(32)	
CBD-5217	4.5	4~52	7~36	7~45	39.2(4000)	92.1(9400)	7000	10.9	RG-52	TK-A853	3.2(32)	
CBD-52	A5	4.5	4~52	7~36	7~45	39.2(4000)	92.1(9400)	7000	7.8	RG-52	TK-A853	3.2(32)
CBD-52	A6	4.5	4~52	7~36	7~45	39.2(4000)	92.1(9400)	7000	9.1	RG-52	TK-A853	3.2(32)
CBD-65	4.5	4~65	8~56	8~46	44.1(4500)	103(10500)	6000	9.3	RG-65	TK-1068	2.7(27)	
CBD-6517	4.5	4~65	8~56	8~46	44.1(4500)	103(10500)	6000	8.6	RG-65	TK-1068	2.7(27)	
CBD-65	A5	4.5	4~65	8~56	8~46	44.1(4500)	103(10500)	6000	10.8	RG-65	TK-1068	2.7(27)
CBD-65	A6	4.5	4~65	8~56	8~46	44.1(4500)	103(10500)	6000	9.5	RG-65	TK-1068	2.7(27)
CBD-65	A8	4.5	4~65	8~56	8~46	44.1(4500)	103(10500)	6000	9.5	RG-65	TK-1068	2.7(27)

DIMENSIONS

Model	A	A1	A2	B	C(H6)	D	D1	E	E1	F	G max.	G min.	H	J	K max.	L	L1	M
CBD-52	150	140	116	99	140	104.8	-	5	-	52	24	19.5	17	56	M60x2	4~M10x20	14.5	57
CBD-5212	140	140	116	99	120	100	-	5	-	52	22	17.5	17	56	M60x2	4~M10x20	14.5	57
CBD-5217	180	140	116	109	170	133.4	-	6	-	52	33	28.5	17	56	M60x2	4~M12x30	18	67
CBD-52	A5	140	140	116	109	-	104.8	82.56	-	52	39	34.5	17	56	M60x2	4~M10x30	16	67
CBD-52	A6	160	140	116	109	-	133.4	106.37	-	52	39	34.5	17	56	M60x2	4~M12x35	18	67
CBD-65	157	157	132	114	140	104.8	-	6	-	54	35	30.5	17.5	68	M75x2	4~M10x30	18	72
CBD-6517	180	157	132	112	170	133.4	-	6	24	54	33	28.5	17.5	68	M75x2	4~M12x30	18	70
CBD-65	A5	157	157	132	112	-	104.8	82.56	-	54	39	34.5	17.5	68	M75x2	4~M10x25	16	70
CBD-65	A6	157	157	132	110	-	133.4	106.38	-	54	37	32.5	17.5	68	M75x2	4~M12x35	18.5	68
CBD-65	A8	202	157	132	114	-	171.4	139.72	-	54	41	36.5	17.5	68	M75x2	4~M16x35	24	72