

- WEDGE-HOOK type 3-jaw high speed power chuck.
- Sealed against swarf, chips and coolant, suitable for vertical lathe.

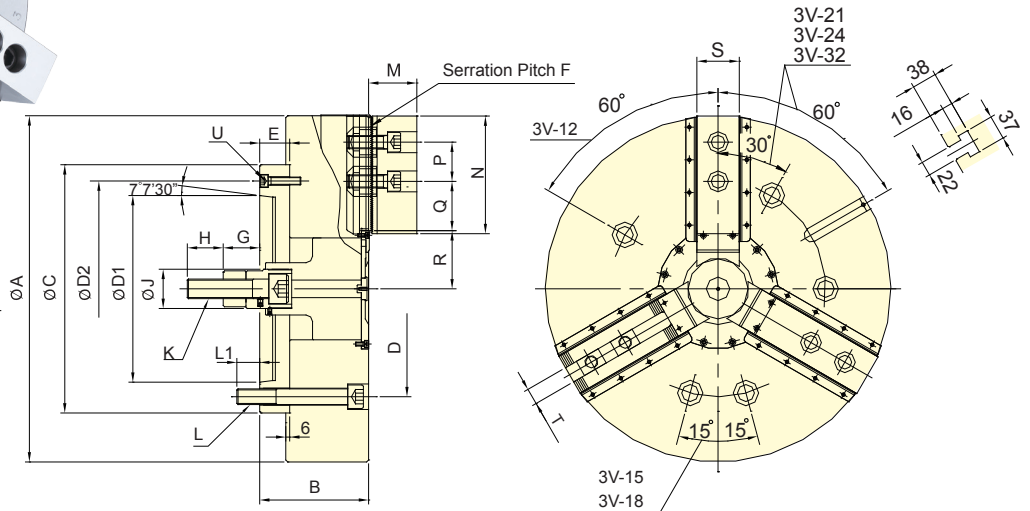
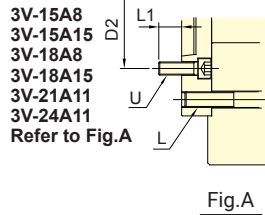

Subject to technical changes

### SPECIFICATIONS

Model	Plunger stroke mm	Jaw stroke (Dia.) mm	Chucking Dia.		Max. D.B. pull kN (kgf)	Max. Clamping force kN (kgf)	Max. speed min <sup>-1</sup> (r.p.m.)	I Moment of inertia kg·m <sup>2</sup>	Weight kg	Matching cyl. RK-150 RE-150 RK-200 RE-200K	Max. pressure MPa (kgf/cm <sup>2</sup> )
			Max. mm	Min. mm							
3V-12	A8	30	12.7	304	30	41(4180)	156(15900)	3150	0.8	66	2.9(29)
3V-15	A8	35	16	381	30	81.9(8360)	245.1(25000)	2900	2.3	130	3.2(32) 3.4(34)
3V-15	A11	35	16	381	30	81.9(8360)	245.1(25000)	2900	2.3	129	
3V-15	A15	35	16	381	30	81.9(8360)	245.1(25000)	2900	2.7	137	
3V-18	A8	35	16	450	80	81.9(8360)	245.1(25000)	2600	3.3	159	
3V-18	A11	35	16	450	80	81.9(8360)	245.1(25000)	2600	3.3	158	
3V-18	A15	35	16	450	80	81.9(8360)	245.1(25000)	2600	3.7	165	
3V-21	A11	35	16	530	62	81.9(8360)	271.6(27700)	1800	5.3	229	
3V-21	A15	35	16	530	62	81.9(8360)	271.6(27700)	1800	5.2	222	
3V-24	A11	35	16	610	136	81.9(8360)	271.6(27700)	1700	7.6	270	
3V-24	A15	35	16	610	136	81.9(8360)	271.6(27700)	1700	7.3	263	
3V-32	A15	35	16	800	136	81.9(8360)	271.6(27700)	1100	36.2	430	

### DIMENSIONS

Model	A	B	C	D	D1	D2	E	F	G max.	G min.	H	J	K	
3V-12	A8	304	141	220	171.4	139.72	190	40	1.5	73	43	36	50	M20x2.5
3V-15	A8	381	164	300	235	139.72	171.4	54	1.5	99	64	55	60	M30x3.5
3V-15	A11	381	168	300	235	196.87	260	58	1.5	95	60	55	60	M30x3.5
3V-15	A15	381	172	380	235	285.78	330.2	62	1.5	91	56	55	60	M30x3.5
3V-18	A8	450	164	300	235	139.72	171.4	54	1.5	99	64	55	60	M30x3.5
3V-18	A11	450	168	300	235	196.87	260	58	1.5	95	60	55	60	M30x3.5
3V-18	A15	450	172	380	235	285.78	330.2	62	1.5	91	56	55	60	M30x3.5
3V-21	A11	530	167	380	330.2	196.87	235	46	3	91	56	55	60	M30x3.5
3V-21	A15	530	167	380	330.2	285.78	330.2	46	3	91	56	55	60	M30x3.5
3V-24	A11	610	167	380	330.2	196.87	235	46	3	91	56	55	60	M30x3.5
3V-24	A15	610	167	380	330.2	285.78	330.2	46	3	91	56	55	60	M30x3.5
3V-32	A15	800	167	380	330.2	285.78	330.2	46	3	91	56	55	60	M30x3.5

Model	L	L1	M	N	P	Q max.	Q min.	R max.	R min.	S	T	U	
3V-12	A8	3~M16	24	54	130	30	47.5	16	61	54.65	50	21	3~M8
3V-15	A8	6~M20	24	66	165	43	51.25	18.25	77.5	69.5	62	25.5	6~M16
3V-15	A11	6~M20	32	66	165	43	51.25	18.25	77.5	69.5	62	25.5	3~M10
3V-15	A15	6~M20	26	66	165	43	51.25	18.25	77.5	69.5	62	25.5	6~M24
3V-18	A8	6~M20	24	66	165	43	51.25	18.25	108	100	62	25.5	6~M16
3V-18	A11	6~M20	32	66	165	43	51.25	18.25	108	100	62	25.5	3~M10
3V-18	A15	6~M20	26	66	165	43	51.25	18.25	108	100	62	25.5	6~M24
3V-21	A11	6~M24	35	74	180	60	93.5	24.5	89	81	65	25	6~M20
3V-21	A15	6~M24	35	74	180	60	93.5	24.5	89	81	65	25	3~M12
3V-24	A11	6~M24	35	74	180	60	93.5	24.5	128	120	65	25	6~M20
3V-24	A15	6~M24	35	74	180	60	93.5	24.5	128	120	65	25	3~M12
3V-32	A15	6~M24	35	74	180	60	189.5	24.5	128	120	65	25	3~M12

- WEDGE-HOOK type 3-jaw high speed power chuck.
- With manual radial setting of master jaws for the workpiece centering.
- Sealed against swarf, chips and coolant, suitable for vertical lathe.

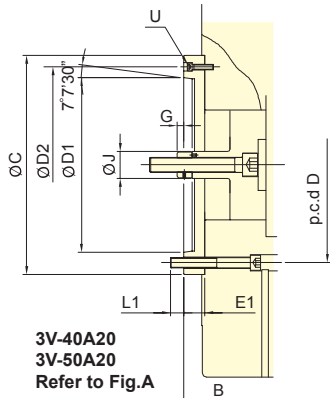

3V-40A20  
3V-50A20  
Refer to Fig.A

Fig.A

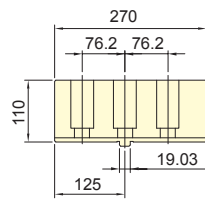
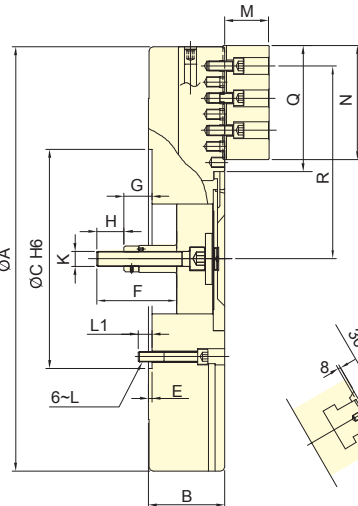

Soft jaw SJ-40~79

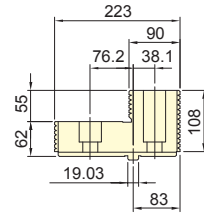
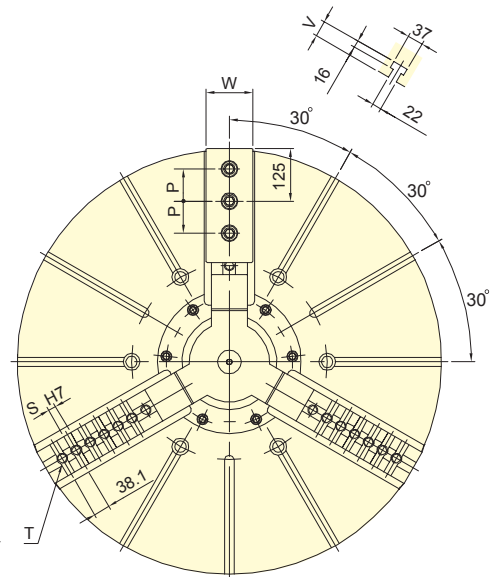

Hardened jaw HJ-40~79

Subject to technical changes

### SPECIFICATIONS

Model	Plunger stroke	Jaw stroke (Dia.)	Chucking Dia.		Max. D.B. pull	Max. Clamping force	Max. speed	I		Weight		Matching cyl.	Max. pressure	
			Max.	Min.				Moment of inertia		kg				MPa (kgf/cm <sup>2</sup> )
	mm	mm	mm	mm	kN (kgf)	kN (kgf)	min <sup>-1</sup> (r.p.m.)	kg-m <sup>2</sup>		kg				
3V-40	A20	57	46+(60)	1005	380	180(18350)	320(32620)	630	68	72	780	849	RK-250 RE-250 RE-A250 RE-L250	4.24(43.2)
3V-50	A20	57	46+(60)	1250	600	180(18350)	320(32620)	500	145	148	1000	1050		4.24(43.2)
3V-63		60	48+(80)	1600	600	200(20390)	360(36700)	400	500	-	1600	-		4.76(46.7)
3V-79		60	48+(80)	2000	1000	200(20390)	360(36700)	320	1250	-	2500	-		4.76(46.7)

### DIMENSIONS

Model	A	B	C	D	D1	D2	E	E1	F	G max.	G min.	H	J	K				
3V-40	A20	1005	184	226	520	463.6	412.78	463.6	8	50	190	123	73	66	16	65	65	M36x4
3V-50	A20	1250	184	226	520	463.6	412.78	463.6	8	50	190	123	73	66	16	65	65	M36x4
3V-63		1600	222	-	720	647.6	-	-	8	-	218	131	-	71	-	65	65	M36x4
3V-79		2000	240	-	720	647.6	-	-	8	-	238	133	-	73	-	65	65	M36x4

Model	L	L1	M	N	P	Q	R max.	R min.	S	T	U	V	W	
3V-40	A20	M24	37	110	270	76.2	295	457	404	6~19.03	7~M24	3~M12	42	84
3V-50	A20	M24	37	110	270	76.2	416	563	510	9~19.03	9~M24	3~M12	42	84
3V-63		M30	46	110	270	76.2	540	738	674	12~19.03	13~M24	-	42	110
3V-79		M30	48	110	270	76.2	740	914	850	16~19.03	17~M24	-	42	110

1. The dimensions and the specifications of 3V-A type are in red data.