

- Thin and lightweight design and increase the z-axis machining range.
- With the center hole cover and dustproof design for the accuracy and service life of the chuck.
- For 5-axis indexing plates and milling machines.
- 3MF series are not designed for the vertical or horizontal lathes, unless there is a rigid plate and providing adequate support rigidity and strength.

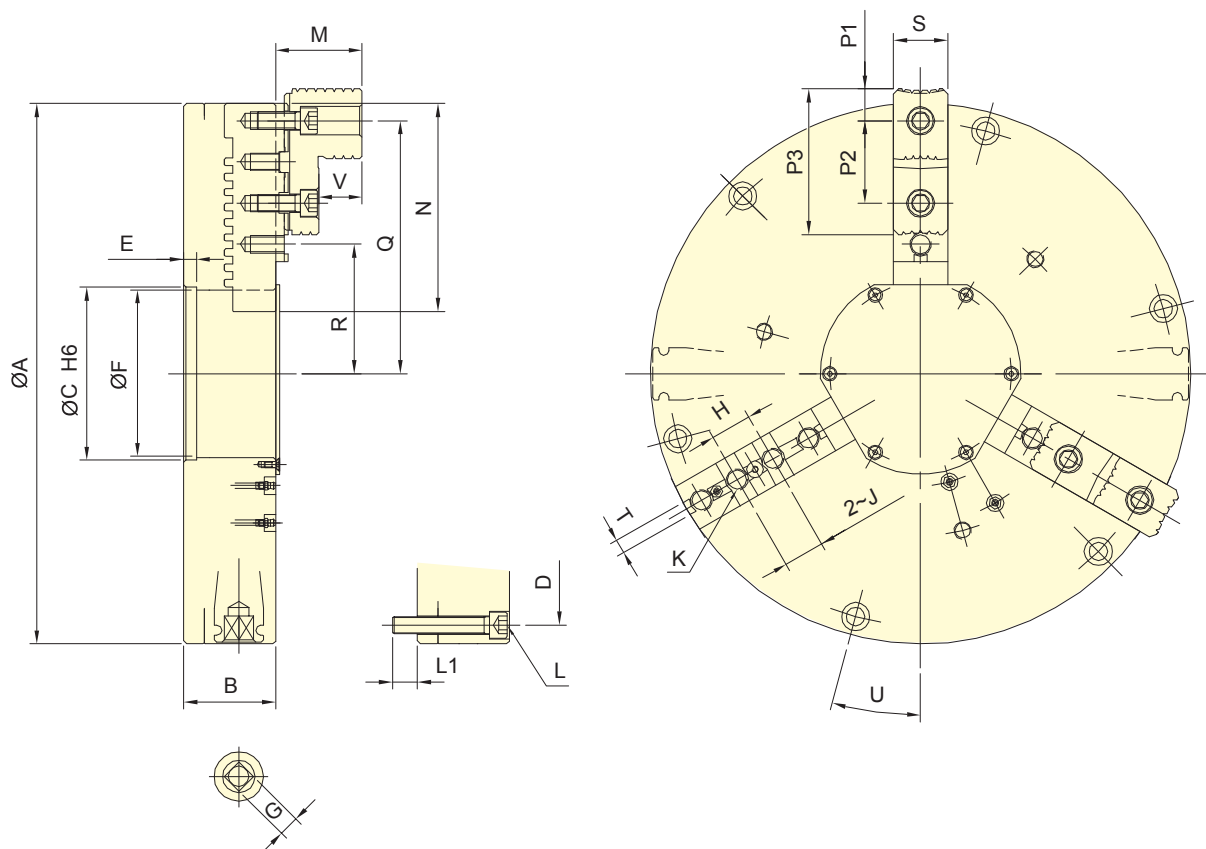

Subject to technical changes

SPECIFICATIONS

Model	Jaw stroke (Dia.) mm	Chucking Dia.		Max. allowable torque N · m (kgf · m)	Max. clamping force kN (kgf)	Max. speed min ⁻¹ (r.p.m.)	Weight kg
		Max.	Min.				
		mm	mm				
3MF-20	80	500	142	170 (17.3)	71.2 (7300)	1150	121

DIMENSIONS

Model	A	B	C (H6)	D	E	F	G	H	J (H7)	K	L	L1	M
3MF-20	500	85	160	465	12	155	□19	38.1	19.03	4~M16	6~M16	23	80

Model	N	P1	P2	P3	Q max.	Q min.	R max.	R min.	S	T (h8)	U	V	Y
3MF-20	192.5	29.5	76.2	135	254	214	139.7	99.7	50	12.7	15°	40	30