

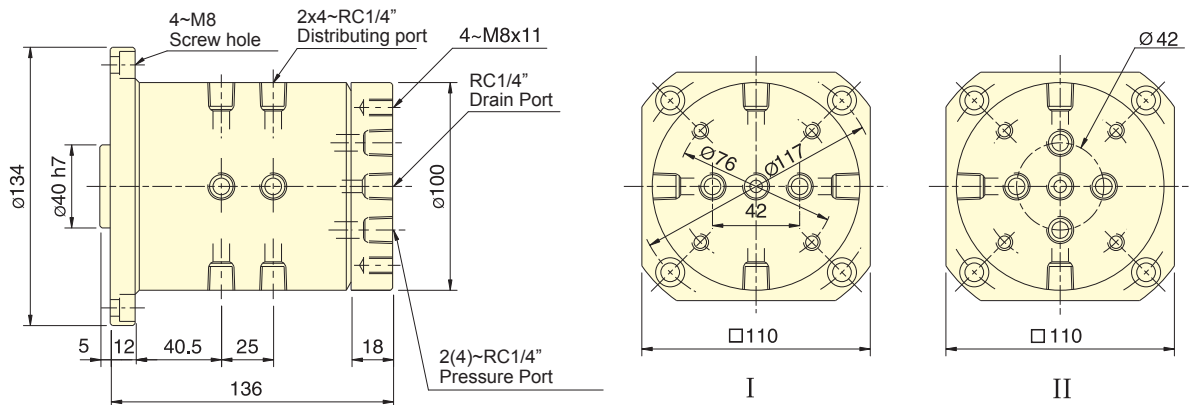

- Rotary valve is used for clamping cylinder on rotary table.
- Through unique design, it can make the rotary housing be rotated light force and is free from oil leaking.
- I Type is a single circuit which controls the clamping.
- II Type is a double circuit which separately controls the clamping.
- The drain port of RV type should be independently connected to oil tank to avoid back pressure.



Subject to technical changes

SPECIFICATIONS

Model	Distributing	Max. pressure	Weight
		MPa(kgf/cm ²)	kg
RV-31H	4 (by order)	4.0 (40)	7.4

Note:RV can be custom-made.

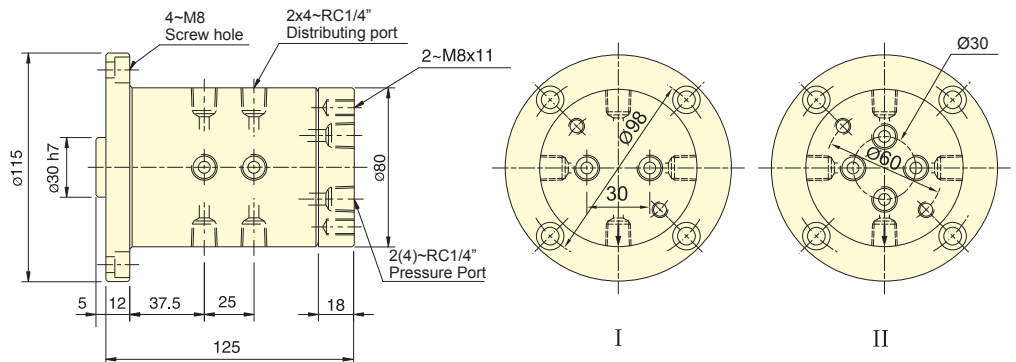

Subject to technical changes

SPECIFICATIONS

Model	Distributing	Max. pressure	Weight
		MPa(kgf/cm ²)	kg
RV-A31H	4 (by order)	0.8 (8)	4.8

Note:RV-A can be custom-made.



- Coolant joint for high speed, high pressure. Usable for oil and water-soluble coolant.
- Seal bushing inside is made of cemented carbide and ceramics, which provide higher wear-resistance.
- The joint should not run without liquid through coolant port.

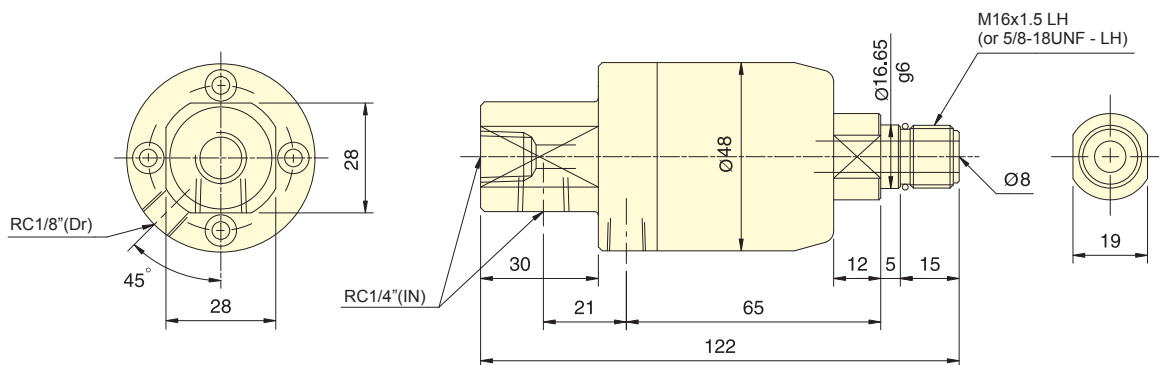

Subject to technical changes

SPECIFICATIONS

Model	PV Limit value MPa · r/m	Max. pressure MPa(kgf/cm ²)	Delivery amount (at 50 kgf/cm ²)	Max. speed (r.p.m.)	Weight (kg)
RJ-80	14400	6.0 (60)	28 l/min	8000	0.5



- Short form, light weight coolant rotating joint.
- Coolant joint for high speed, high pressure. Usable for oil and water-soluble coolant.
- Seal bushing inside is made of cemented carbide and ceramics, which provide higher wear-resistance.
- The seal will depart automatically if no liquid passes during operation, and will not be damaged due to dry touching.
- Min. pressure is 4kgf/cm².

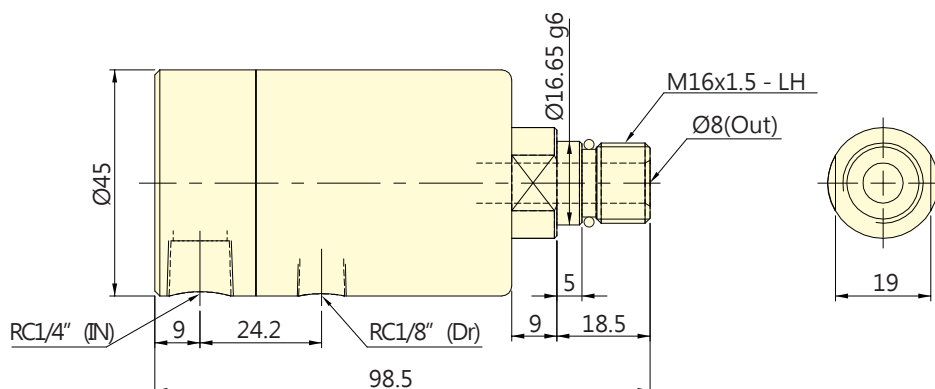

Subject to technical changes

SPECIFICATIONS

Model	PV Limit value MPa · r/m	Max. pressure MPa(kgf/cm ²)	Delivery amount (at 50 kgf/cm ²)	Max. speed (r.p.m.)	Min. pressure MPa(kgf/cm ²)	Weight (kg)
RJ-92	17500	7.0(70)	28 l/min	10000	0.4 (4)	0.46